



## Rack 16T Classic

Electrical Supply

CODE: 925915220

Trays	16T 40x60 46x66 cm
Outside dimension	850 L x 963 P x 1860 H mm
Tray distance	80 mm
Power	32 kW
Weight	177 Kg
Max temperature	270° C
Power supply	400 V ~ 3PH + N + PE 400 V ~ 2PH + N + PE 230 V ~ 3PH + PE 230 V ~ 1PH + N + PE 50-60 Hz

### Equipment

Led illumination	BakeAIR multi-fan system	Double low emissive glass
High-performance thermal insulation	Blue LED for chamber cleaning check	Five fan speeds and semi-static cooking
Nine cooking modes	Automatic chimney opening BakeDRY	Program blocking with password
Rounded baking chamber	CE Certificate	Automatic control of dry/steam balance inside the chamber
Steam control in percentage BakeSTEAM	Automatic control of the cooking level and load	Multi-timer function for multiple and mixed cooking
Storage, viewing* and exportation of cooking data (haccp)	Customized programs mode	Manual mode
Preset programs mode	EAC certification	Automatic preheating
Cooling program	Delayed start programming	Delayed cooking programming
Pre-loaded and online cookbook	Automatic detection and errors report	Openable inner glass for easy cleaning
Fan inversion, speed control and motor brake		

### Options

Heart probe MultiBakePOINT	BakeCLEAN automatic washing system	Safety rinse
Left door opening	Data logger for USB connection	Extendable height-adjustable feet kit

Rack 16T Classic

Electrical Supply

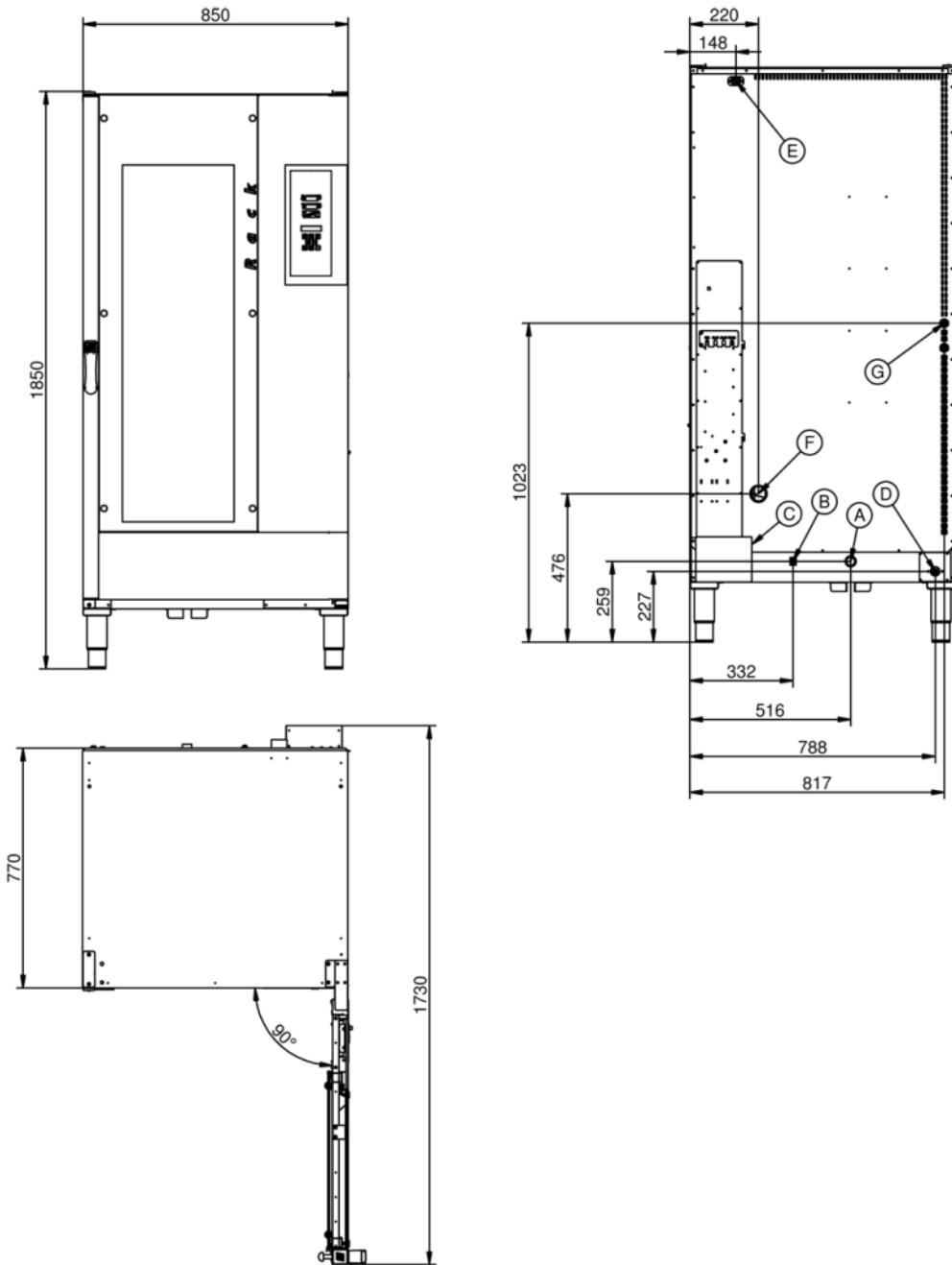

**Legend**

- A - Drain liquid Ø 30mm
- B - Equipotential terminal comb
- C - Electric supply
- D - Water inlet 3/4"
- E - Extracting hood supply
- F - Steam exhaust Ø 50mm

- G - Inlet for washing kit Ø 8mm
- H - Depressurizer Ø 12mm

Rack 16T Classic

Electrical Supply

Supply and Connections

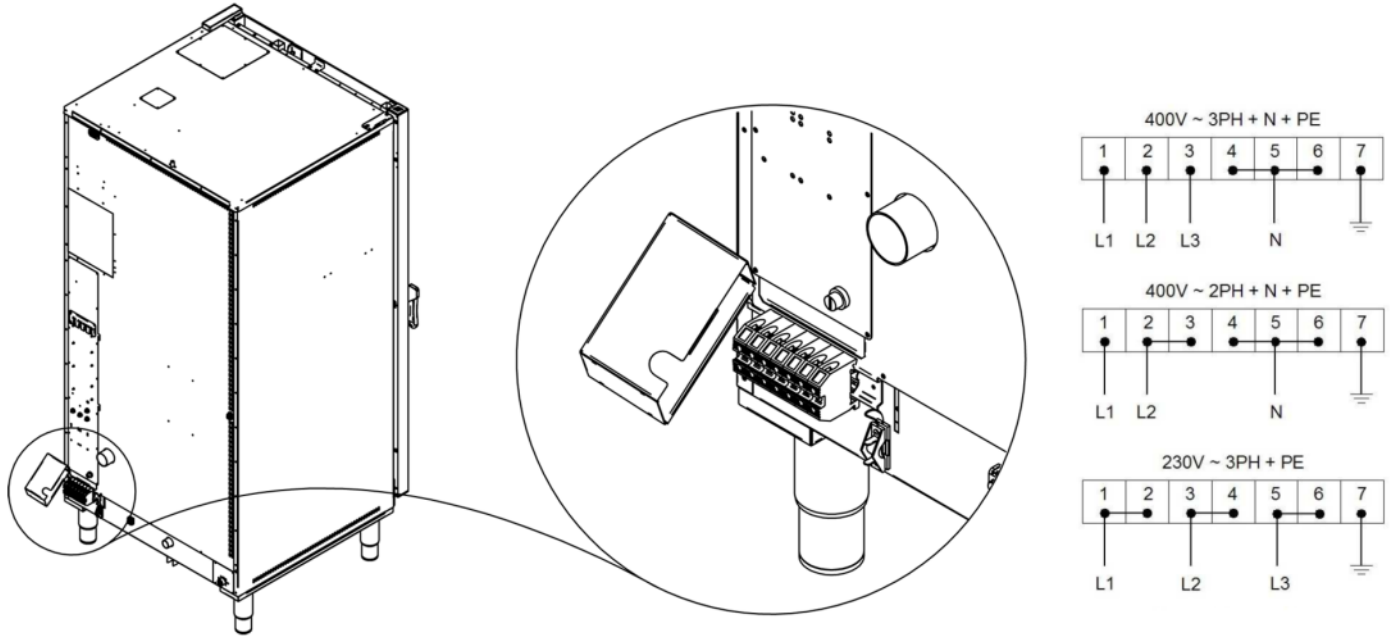

Packaging

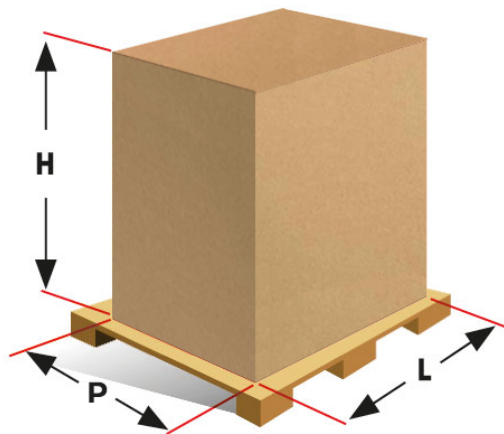

Packing size:	950 L x 1040 P x 2090 H mm
Net weight:	177 Kg
Gross weight:	233 Kg